

GEHL

Form No.

913364

Revision B

March

2014

RT250

Compact Track Loader



Parts Manual

INTRODUCTION

When ordering service parts, specify the correct part number, full description, quantity required, the machine model number, and serial number. For your safety, and continued proper operation, use only genuine Gehl service parts.

“Right” and “Left” are determined from a position sitting on the seat inside the cab and facing forward.

Gehl Company reserves the right to make changes or improvements in the design or construction of any part of the machine without incurring the obligation to install such changes on previously delivered machines.

The following icons shown on various pages provide important information or identify where additional information can be found.

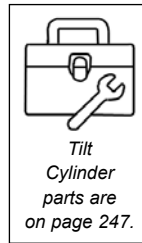

Identifies where additional pages for component parts, seals, and kits can be found.

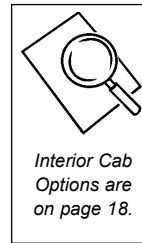

Identifies where additional information can be found.

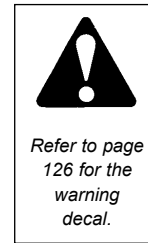

Alerts and directs user to investigate more information.

SERIAL NUMBER

GEHL

Compact Track Loader
Gehl Company West Bend WI 53095 USA

Product
Identification
Number

Model	Power	Rated Capacity	Operating Mass

Serial number breaks are indicated as follows:

- (SN 999 and before) - indicates serial numbers up to and including 999.
- (SN 1000 - 2000) - indicates serial numbers from 1000 to 2000.
- (SN 999 and up) - indicates serial numbers including 999 and after.

NOTE: When ordering parts, be sure to identify the last five digits of the machine's serial number.

HYDRAULIC AND ELECTRICAL SCHEMATICS

Hydraulic and electrical schematics can be found in the Operator's and Service Manuals for this machine; please refer to the information at the right for the correct manual.

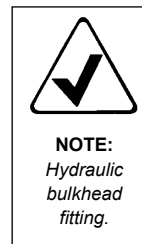

Identifies missing, hidden parts, or adds informational comments.



Seal Kit



Repair Kit



Represents a port designation on hydraulic components (e.g., valves, cylinders, etc.)

SOME ABBREVIATIONS LISTED IN THIS MANUAL

ASSY	Assembly
AR	As Required
CFPD	Contact Factory Parts Department
EU	European Union (standards)
HYD	Hydraulic
IN	Inch(es)
INC/INCL	Included or includes
LN	Lock Nut
MM/mm	Millimeter
NA	Not Applicable or Not Available
NPT	National Pipe Thread
NSS	Not Sold Separately
ORB	O-Ring Boss
REF	Reference
SN	Serial Number
W/	With
W/O	Without

RELATED MANUALS

Engine Parts Manual: P/N 50960058

TABLE OF CONTENTS

Introduction	i
Table of Contents	1
Filters / Belts / Analysis Kits	4
Cab	6
Standard Cab	6
Cab Door - Swing-Out (Option)	8
Cab Door - Latches (Optional Swing-Out Door)	10
Side Windows (Option)	11
Cab Tilt and Rear Window	12
Window Washer (Option)	14
Foot Pod / Accelerator Pedal	15
Interior Covers	16
Headliner - Heat-A/C Ducts (Option)	18
Console Controls - Left Side	20
Console Controls - Right Side	21
Console - Right Side - (<i>Late Style</i>)	22
Console - Left Side - (<i>Late Style</i>)	23
Console - Right Side - (<i>Early Style</i>)	24
Console - Left Side - (<i>Early Style</i>)	25
Seat	26
Mirror (Option)	28
Radio (Option)	29
Heater Hose Circuit (Option)	30
Air Conditioning Circuit (Option)	32
Heater / Air Conditioning Blower (Option)	34
Rear Cab - HVAC Cover	36
Chassis	38
Frame - Front / Under	38
Center Frame	39
Counter Weights	40
Rear Door	42
Rear Access Doors	44
Rear Hood - (No Air Conditioning)	46
Rear Hood - Air Conditioning Condenser Assembly	48
Electrical	50
Chassis Wire Harness / Components	50
Main Fuse Box / Fuses / Relays	52
Battery Circuit / Engine Wire Harness	54
Operator Wire Harness	56
Work Lights Cab / ROPS Wire Harness	57

TABLE OF CONTENTS

Engine	58
External Components	58
External Components - Mounts	60
External Components - Flywheel Housing	61
Fuel Circuit	62
Fuel Tank	64
Air Intake	66
Exhaust	68
Air Conditioning Compressor (Option)	70
Engine / Hydraulics	72
Radiator / Hydraulic Cooler (<i>Late Style</i>)	72
Radiator / Hydraulic Cooler (<i>Early Style</i>)	74
Tracks	76
Track Assembly	76
Dual-Flange Idler Assembly	78
Dual-Flange Bogie Wheel Assembly	79
Front Idler Assembly	80
Track Drive Motor and Sprocket	81
Track Drive Motor Components	82
Loader Arm	84
Bolt-On Components	84
Attachment Bracket - Manual (Standard)	86
Bucket	87
Attachment Bracket - Power All-Tach [®] (Option)	88
14-Pin Connector (Option)	90
Tilt Circuit Hydraulics	92
Lift Circuit Hydraulics	94
Auxiliary Hydraulics Circuit - (Standard)	96
High-Flow Hydraulics Circuit - (Option)	98
Hydraulic System	100
Hydraulic Tank (<i>Late Style</i>)	100
Hydraulic Tank (<i>Early Style</i>)	102
Hydraulic Filter Assembly	104
Hydrostatic Drive Pump Circuit	106
Track Drive Circuit - Right Side	108
Track Drive Circuit - Left Side	110
Pilot Pressure Manifold Circuit	112
Hydraulic Pump Circuit - (Standard Hydraulics)	114
Hydraulic Pump Circuit (High-Flow Hydraulics - Option)	116
Auxiliary / High-Flow Hydraulics Circuit	118
Self-Level Circuit	120
Float/Lift Circuit - (Standard) / Hydraglide [™] Ride Control - (Option)	122

TABLE OF CONTENTS

Hydraulic Components	124
Hydrostatic Drive Pump	124
Hydraulic Pump - Standard Hydraulics	126
Hydraulic Pump - High-Flow Hydraulics	127
Hydraulic Main Valve - (Standard Hydraulics)	128
Hydraulic Main Valve - (High-Flow Hydraulics)	129
Self-Level Valve - (Standard)	130
Self-Level Valve - (Switchable)	131
Float Manifold - (Standard)	132
Hydraglide™ Ride Control Manifold (Option)	133
Pilot Pressure Manifold	134
Track Tension Cylinder	135
Tilt Cylinder	136
Lift Cylinder	137
Decals	138
Paint / Decal Application / General Information	138
Front	139
Right Side (<i>Late Style</i>)	140
Left Side (<i>Late Style</i>)	141
Right Side (<i>Early Style</i>)	142
Left Side (<i>Early Style</i>)	143
Rear	144
Engine Compartment	145
Numerical Index	146
Subject Index	154
Reference	160
O-Ring Tables	160
Adapter (Fittings) Torque Guide	161
Metric Bolt Torque Guide	162
SAE and Metric Bolt Torque Guide	163

RT250 - MAINTENANCE

FILTERS / BELTS / ANALYSIS KITS

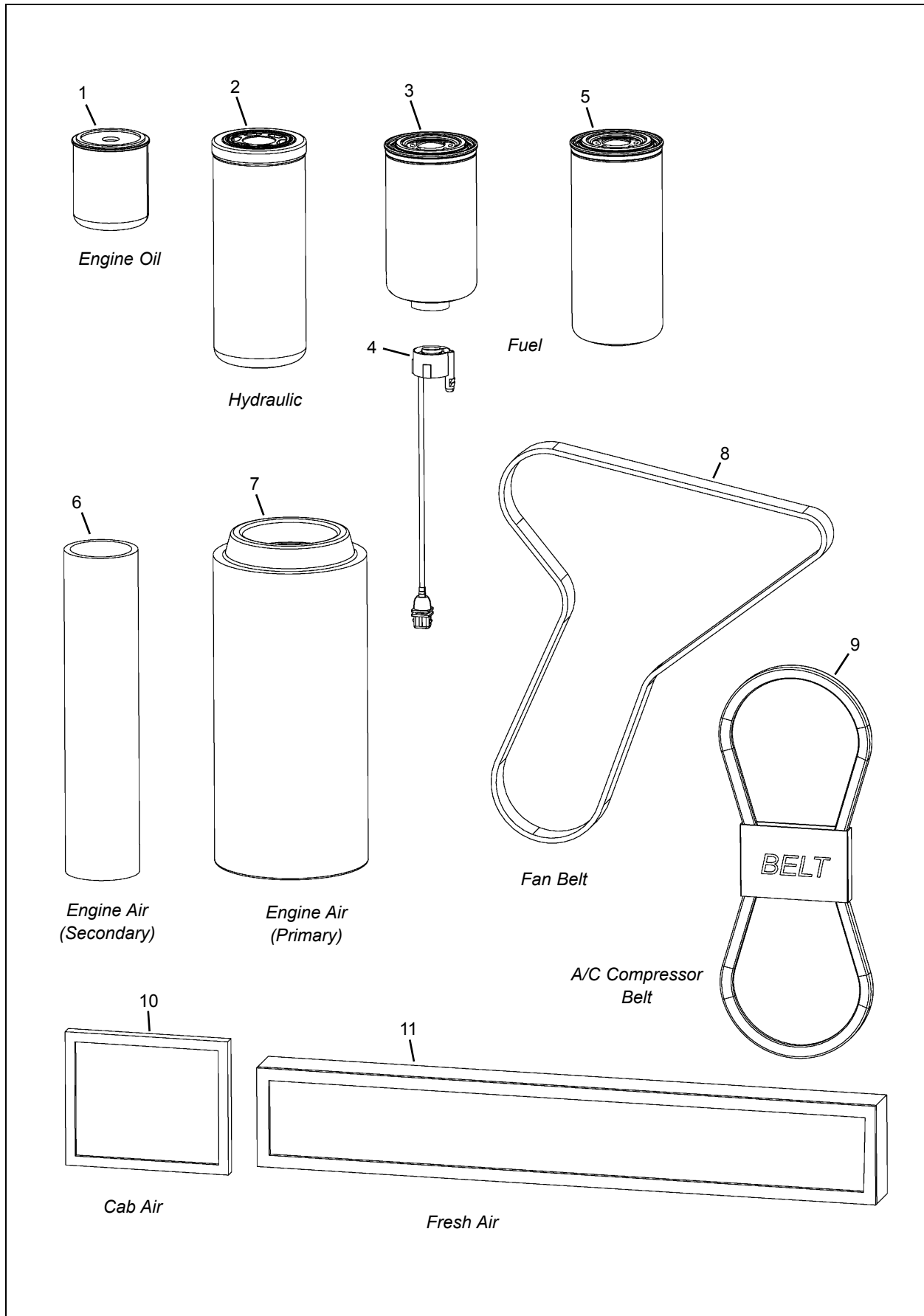

RT250 - MAINTENANCE FILTERS / BELTS / ANALYSIS KITS

Item			
No.	Part No.	Description	Qty.
01	132023	FILTER, ENGINE OIL	1
02	074830	FILTER, HYDRAULIC	1
03		FILTER, FUEL/WATER SEPARATOR	1
	50303847	<i>Note a</i>	
	50302445	<i>Note b</i>	
04	50220612	SENSOR, WATER	1
	50220613	SEALING RING <i>(not shown — goes between sensor and water separator)</i>	
05	50302441	FILTER, FUEL <i>(secondary)</i>	1
06	184195	FILTER, ENGINE AIR <i>(secondary)</i>	1

Item			
No.	Part No.	Description	Qty.
07	184146	FILTER, ENGINE AIR <i>(primary)</i>	1
08	50220511	BELT/ALTERNATOR-FAN	1
09	50301193	V-BELT A x 41 * <i>(A/C Compressor)</i>	1
10	242832	FILTER, RECIRCULATION AIR *	2
11	195660	FILTER, FRESH AIR *	1

- a Engine SN 11538281 and up
- b Engine SN 11538280 and before

* Used when equipped with air conditioning or heater.

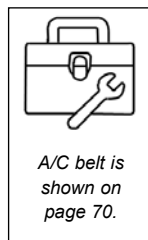
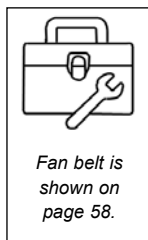
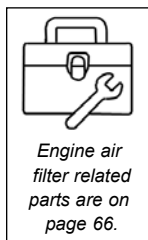
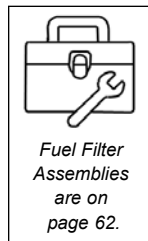
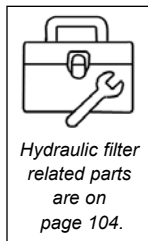

Analysis Kits*	
	Qty.
272806	HYDRAULIC OIL ANALYSIS KITS (10)
272809	ENGINE OIL ANALYSIS KITS (10)
272811	BASIC FUEL ANALYSIS KIT (1)
272812	COOLANT ANALYSIS KITS (10)
272813	FIELD TEST COOLANT STRIP KIT (1)
272814	OIL VACUUM PUMP (1)
272815	COOLANT VACUUM PUMP (1)
272816	1/4" PLASTIC TUBING (100-FOOT ROLL)
* For the analysis of fluids and lubricants used in this machine. Contact your dealer for more information.	

RT250 - CAB STANDARD CAB

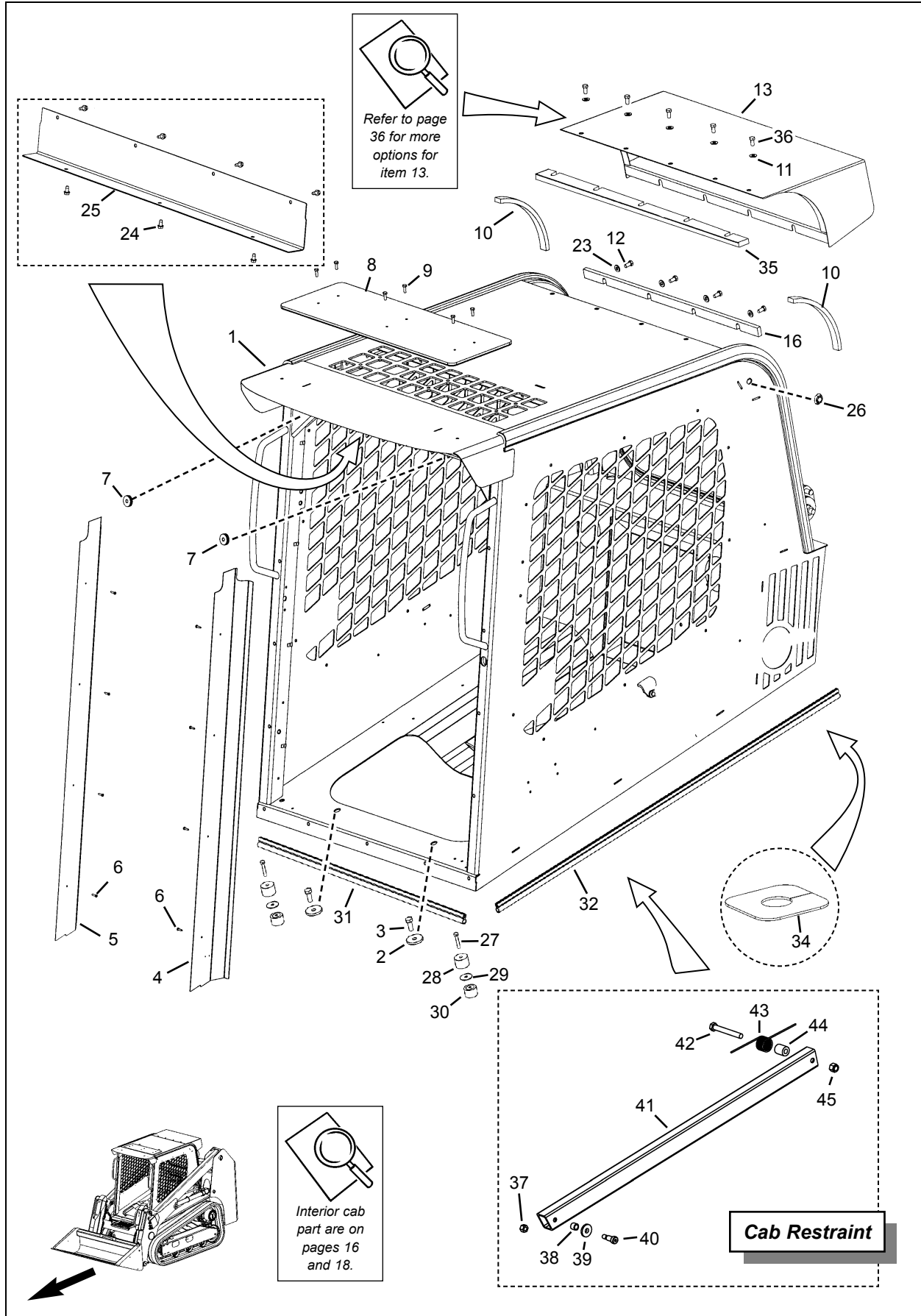

**RT250 - CAB
STANDARD CAB**

Item No.	Part No.	Description	Qty.
01	50302312	ROPS WELDMENT	1
02	057557	FW 17/32 ZY	2
03	650495	CS 1/2" x 1-1/4" C5ZY	2
04		COVER, POST (Left) (see below)	1
	50300218	(Standard - no door)	
	50300210	(Swing-Out Door - w/ heater)-(Option)*	
	50300215	(Swing-Out Door - no heater)-(Option) *	
05		COVER, POST (Right) (see below)	1
	50300219	(Standard - no door)	
	50300212	(Swing-Out Door - w/ heater)-(Option)*	
	50300216	(Swing-Out Door - no heater)-(Option) *	
06	651783	SCREW, TPH TF CR #8-32x3/4 CZY	8
07	242633	GROMMET, 0.375"x0.188GW 1.0	2
08	270848	WINDOW, TOP	1
09	650835	CS 1/4" x 1" C5ZY	6
	137462	WASHER, 1/4" SEALING	6
10	271627	SEAL, FOAM SIDE	2
11	135270	WASHER, SEALING 3/8"	5
12	650488	CS 3/8" x 3/4" C5ZY	4
13	50301826	WELDMENT, REAR BILL **	1
14	654004	FW 5/16" AWZY	2
23	654049	FW 3/8 ANZY	4
24	651783	SCREW/TPHTF CR *8-32x3/4	7
	650606	FW #8 AZ (not shown)	7
25	50300057	COVER, DOOR HEADER	1

Item No.	Part No.	Description	Qty.
26	192182	PLUG, RUBBER	2
27	650568	CS 5/16" x 2" C5ZY	2
28	50301141	SPACER	2
29	50301434	SPACER	AR
30	275016	ISOLATOR, 1" x 1-1/2" RUBBER	2
31	50301581	SEAL, BULB 0.63" x 37.5"	1
32	50301580	SEAL, BULB 0.63" x 56.25"	2
34	50301118	GROMMET, CAB ELECTRICAL	1
35	50301824	SEAL, FOAM	1
36	650490	CS 3/8" x 1" C5ZY	5
37	210-31017	LN FL CTR 5/16 CFZY	1
38	50302309	BUSHING, BRONZE	1
39	50302473	WASHER, BEVELED	1
40	030-31941	SCREW, SHOULDERED 3/8 "x5/8"	1
41	50302182	CAB RESTRAINT, WELDMENT	1
42	650818	CS 3/8" x 3" C5ZY	1
43	50301852	SPRING, TORSION	1
44	50302181	SPACER	1
45	067847	HLN INST 3/8" CZY	1

* When machine is equipped with optional swing-out door.

** Refer to page 36 for additional rear bill weldments.
Units equipped with heaters or air conditioning (HVAC) use a different rear bill weldment.

RT250 - CAB CAB DOOR - SWING-OUT - (OPTION)

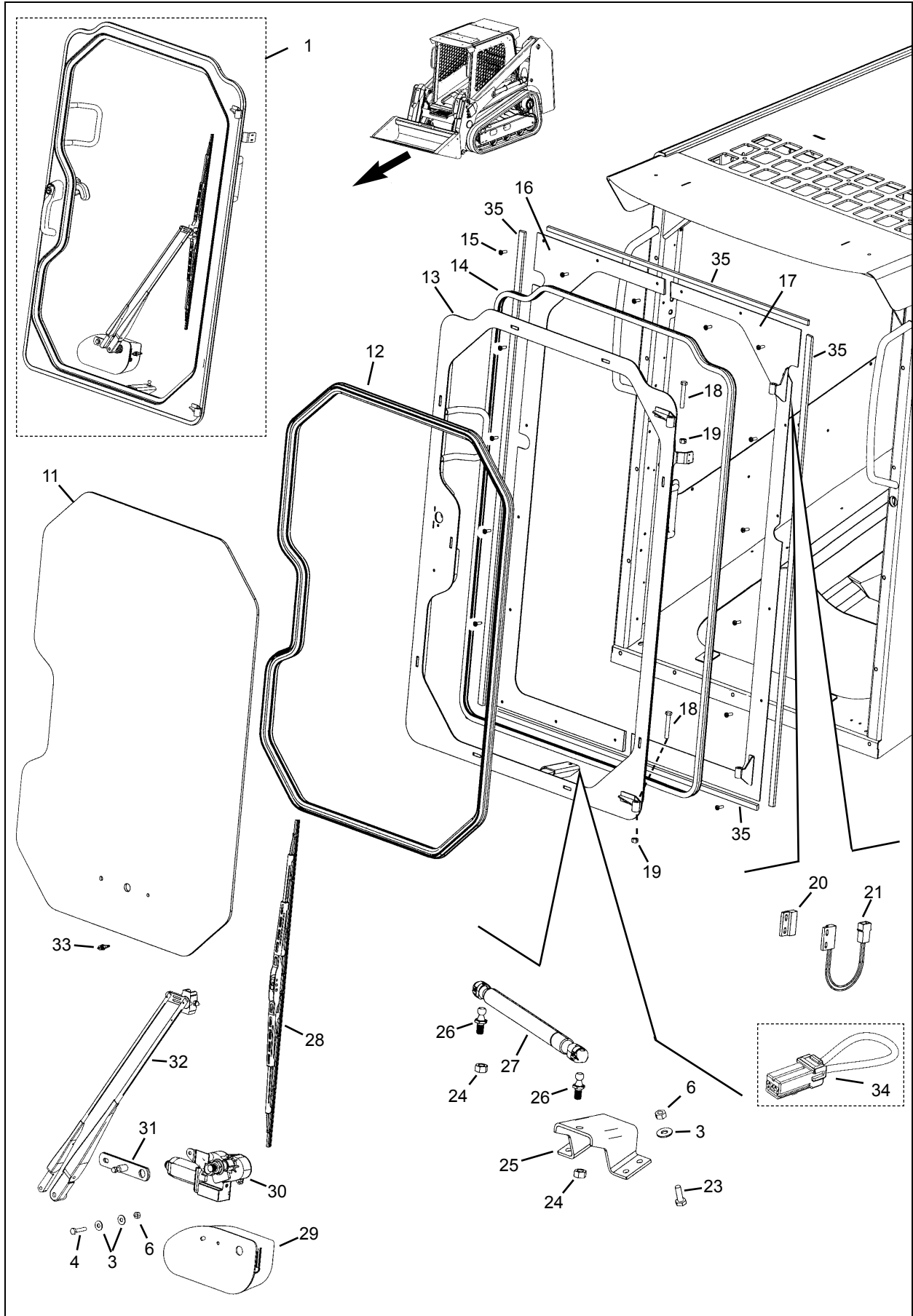

Thanks for your reading.

Please click here to download complete manual instantly.

And can also choose other manuals.

Feel free --->write to me with any questions.

Our service email:

manuals007@hotmail.com