

# **ELECTRICAL SYSTEM**

**S50CT, S50CT2 [B267];H2.0-2.5CT (H50CT) [B274]**

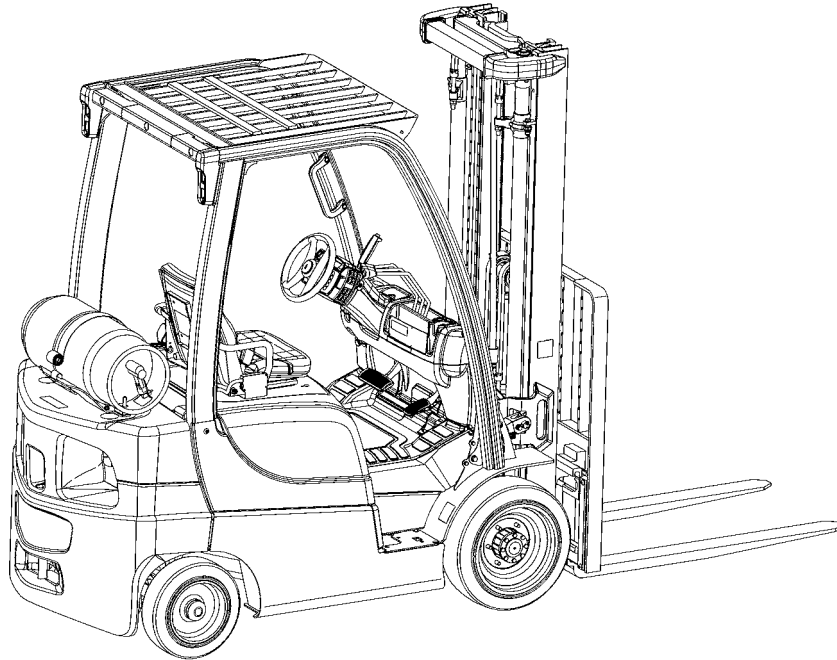

# ***HYSTER***

# SAFETY PRECAUTIONS

## MAINTENANCE AND REPAIR

- The Service Manuals are updated on a regular basis, but may not reflect recent design changes to the product. Updated technical service information may be available from your local authorized Hyster® dealer. Service Manuals provide general guidelines for maintenance and service and are intended for use by trained and experienced technicians. Failure to properly maintain equipment or to follow instructions contained in the Service Manual could result in damage to the products, personal injury, property damage or death.
- When lifting parts or assemblies, make sure all slings, chains, or cables are correctly fastened, and that the load being lifted is balanced. Make sure the crane, cables, and chains have the capacity to support the weight of the load.
- Do not lift heavy parts by hand, use a lifting mechanism.
- Wear safety glasses.
- DISCONNECT THE BATTERY CONNECTOR before doing any maintenance or repair on electric lift trucks. Disconnect the battery ground cable on internal combustion lift trucks.
- Always use correct blocks to prevent the unit from rolling or falling. See HOW TO PUT THE LIFT TRUCK ON BLOCKS in the **Operating Manual** or the **Periodic Maintenance** section.
- Keep the unit clean and the working area clean and orderly.
- Use the correct tools for the job.
- Keep the tools clean and in good condition.
- Always use **HYSTER APPROVED** parts when making repairs. Replacement parts must meet or exceed the specifications of the original equipment manufacturer.
- Make sure all nuts, bolts, snap rings, and other fastening devices are removed before using force to remove parts.
- Always fasten a DO NOT OPERATE tag to the controls of the unit when making repairs, or if the unit needs repairs.
- Be sure to follow the **WARNING** and **CAUTION** notes in the instructions.
- Gasoline, Liquid Petroleum Gas (LPG), Compressed Natural Gas (CNG), and Diesel fuel are flammable. Be sure to follow the necessary safety precautions when handling these fuels and when working on these fuel systems.
- Batteries generate flammable gas when they are being charged. Keep fire and sparks away from the area. Make sure the area is well ventilated.

**NOTE:** The following symbols and words indicate safety information in this manual:



### **WARNING**

Indicates a hazardous situation which, if not avoided, could result in death or serious injury.



### **CAUTION**

Indicates a hazardous situation which, if not avoided, could result in minor or moderate injury and property damage.

On the lift truck, the **WARNING** symbol and word are on orange background. The **CAUTION** symbol and word are on yellow background.

## TABLE OF CONTENTS

General .....	1
Engine Control Module (ECM), Yanmar Diesel Engine .....	2
Remove .....	2
Install .....	2
Display Switch Cluster .....	2
Remove .....	3
Install .....	5
Direction Control Lever .....	5
Remove .....	5
Install .....	6
Key Switch .....	6
Remove .....	6
Install .....	7
Display Switch Cluster Panel Bezel and Overlay .....	7
Remove .....	7
Install .....	7
Steering Column Repair .....	7
Remove .....	8
Disassemble .....	9
Assemble .....	9
Install .....	10
Sensors and Switches .....	10
General .....	10
Dash Panel, Kick Panel, and Seal Plate, Remove and Install .....	10
Remove .....	10
Install .....	11
Accelerator Pedal Position Sensor .....	11
Remove .....	11
Install .....	13
Brake Fluid Level Switch .....	14
Remove .....	14
Install .....	14
Brake Pedal Position Sensor .....	15
Remove .....	15
Install .....	16
Parking Brake Position Sensor .....	16
Remove .....	16
Install .....	16
Seat Sensor (Operator Presence System) .....	17
Non-Suspension Seat .....	17
Remove .....	17
Install .....	18
Full Suspension Seats .....	18
Remove .....	18
Install .....	18
Transmission Pressure Sensors (Transducers) .....	19
Remove .....	19
Install .....	19
Transmission Temperature Sensor .....	19
Remove .....	19
Install .....	20
Rear Horn Button Switch .....	20

**TABLE OF CONTENTS (Continued)**

Remove .....	20
Install .....	20
Engine and Fuel Sensors and Switches, PSI 2.4L Dual Fuel Trucks .....	21
Engine and Fuel Sensors, Yanmar 2.6L Diesel Trucks .....	21
Engine Speed Sensor .....	21
Remove .....	21
Install .....	22
Oil Pressure Sensor .....	22
Remove .....	22
Install .....	22
Engine Coolant Temperature (ECT) Sensor .....	23
Remove .....	23
Install .....	23
Fuel/Water Separator Sensor .....	23
Remove .....	23
Install .....	24
Glow Plug Relay .....	24
Remove .....	24
Install .....	26
Power Distribution Module (PDM) and Component Parts .....	26
Power Distribution Module (PDM) as a Unit .....	26
Remove .....	26
Install .....	27
Power Distribution Module (PDM) Components .....	28
Remove and Install .....	28
Battery .....	28
Remove .....	28
Install .....	28
Lights .....	28
Work Lights (Front and Rear) .....	29
Remove .....	29
Install .....	29
Strobe Light .....	29
Remove .....	30
Install .....	30
LED Tail, Backup, and Brake Lights .....	30
Remove .....	30
Install .....	31
Reflectors .....	31
Remove .....	31
Install .....	31

This section is for the following models:

(S50CT, S50CT2) [B267];  
H2.0-2.5CT (H50CT) [B274]

## General

The removal and replacement procedures for the following electrical components are covered in this manual:

- Display Switch Cluster
- Power Distribution Module (PDM)
- Lights
- Sensors and switches
- Battery

Some of the components used are made of plastic. When using screws to replace and install plastic components, the screws should be rotated counterclockwise until the screw thread turns over the last thread in the plastic part. The screw can then be turned clockwise to make a connection. This prevents "cutting" new threads and damaging the existing thread in the plastic part.

If any welding must be done, obtain proper authorization from a Resident Service Engineer. If authorization is given, be sure to follow the procedures in the **CAUTION** below.



### CAUTION

**When welding, always disconnect the negative battery cable from battery and disconnect the ground wire from the ground stud on the frame. See Figure 1. To prevent damage to the Electronic Control Unit (ECU), remove it from the lift truck.**

For lift trucks equipped with LPG engine see **Fuel System PSI 2.4L 0900SRM1757** for procedure to remove ECU from lift truck.

For lift trucks equipped with diesel engines see section Engine Control Module (ECM), Yanmar

Diesel Engine in this manual for procedure to remove ECM from lift truck.

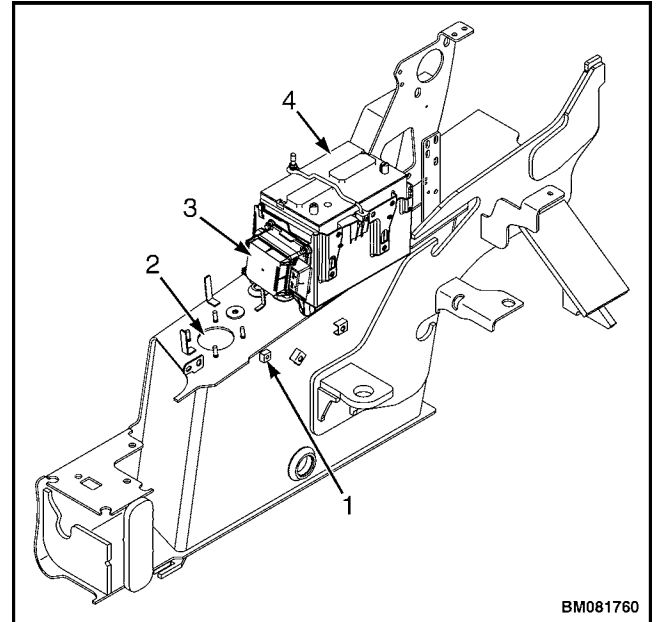

**NOTE:** VIEW SHOWN IS FROM THE LEFT SIDE. MAJOR COMPONENTS AND ELECTRICAL CONNECTIONS NOT SHOWN FOR CLARITY.

1. GROUND STUD
2. TANK OPENING FOR HYDRAULIC FILTER
3. POWER DISTRIBUTION MODULE (PDM)
4. BATTERY

**Figure 1. Welding Preparation**

For more information on how to perform welding repairs to lift truck and overhead guard, see **Periodic Maintenance 8000SRM1774**.

## Engine Control Module (ECM), Yanmar Diesel Engine

### REMOVE

**NOTE:** ECM for Yanmar engine is located on left-hand side of frame.

1. Disconnect negative battery cable.
2. Remove two conduit clips from wire harness and bracket. See Figure 2.
3. Disconnect ECM connector from ECM. See Figure 2.
4. Remove four capscrews and ECM from bracket. See Figure 2.
5. Remove capscREW and bracket from frame. See Figure 2.

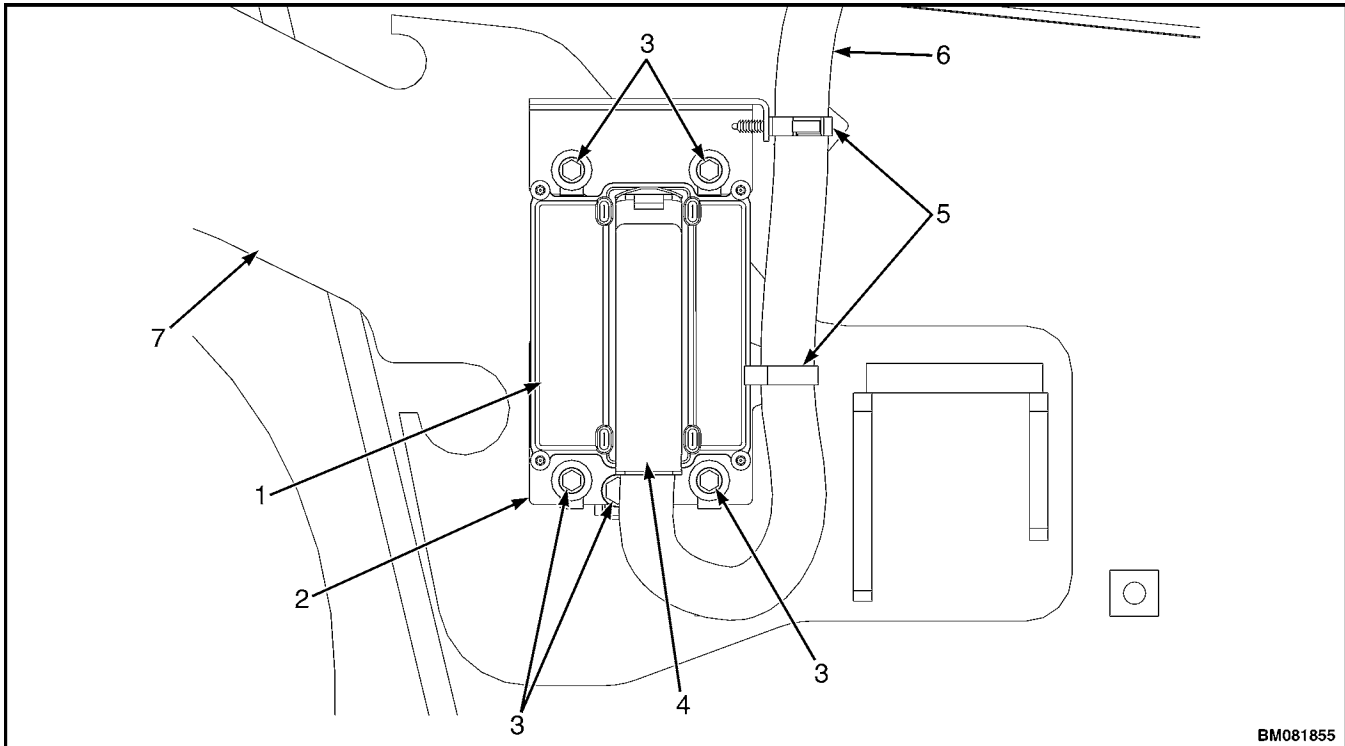

BM081855

- |                  |                 |
|------------------|-----------------|
| 1. ECM           | 5. CONDUIT CLIP |
| 2. BRACKET       | 6. WIRE HARNESS |
| 3. CAPSCREW      | 7. FRAME        |
| 4. ECM CONNECTOR |                 |

**Figure 2. ECM, Yanmar Diesel Engine**

### INSTALL

1. Install bracket and capscREW on frame. See Figure 2.
2. Install ECM and four capscREWS on bracket. See Figure 2.
3. Connect ECM connector to ECM. See Figure 2.
4. Install two conduit clips to wire harness and bracket. See Figure 2.
5. Connect negative battery cable.

## Display Switch Cluster

### REMOVE

**NOTE:** The Display Switch Cluster is a non-repairable part. See **Parts Manual** for replacement part number.

1. Disconnect ground wire.
2. Lift up on the steering wheel slightly and pull up on the tilt lever. Fully lower the steering column.

3. Remove upper steering column cover by pulling up on upper steering column cover to release the latches (one on either side), and pulling cover away from steering column. See Figure 3.

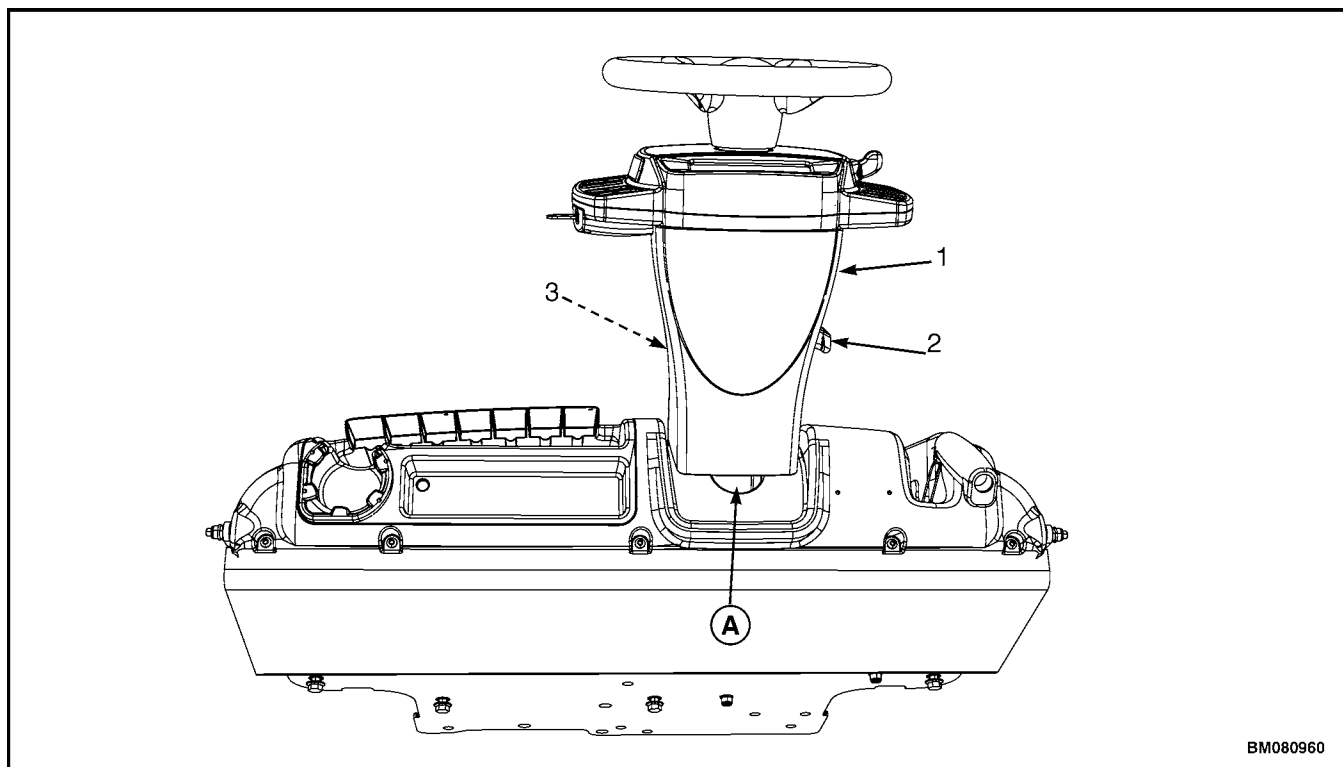

**NOTE:** TOP VIEW OF DASH SHOWN.

A. INDICATES TO PULL UP TO UNLATCH

1. UPPER STEERING COLUMN COVER
2. STEERING COLUMN TILT LEVER

3. LOWER STEERING COLUMN COVER

**Figure 3. Upper Steering Column Cover Removal**

4. Remove the horn button and disconnect the horn wires.

5. Remove the lock nut securing the steering wheel and remove steering wheel from steering column. Take care to not damage the horn wires. See Figure 4.

**NOTE:** A puller tool may be required to remove the steering wheel.

**Thanks for your reading.**

**Please click here to download complete manual instantly.**

**And can also choose other manuals.**

**Feel free --->write to me with any questions.**

**Our service email:**

**manuals007@hotmail.com**