

1. Trim along dashed line.
2. Slide into pocket on Binder Spine.

TYPE 1-4

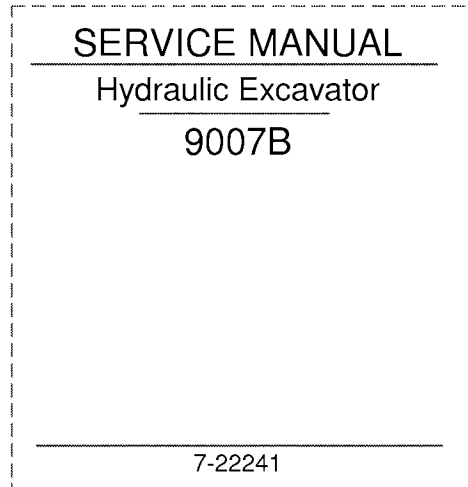

1. Trim along dashed line.
2. Slide into pocket on Binder Spine.

TYPE 1-4

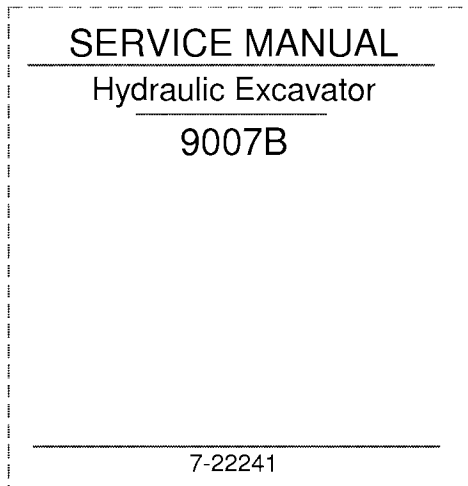

1. Trim along dashed line.
2. Slide into pocket on Binder Spine.

TYPE 1-4

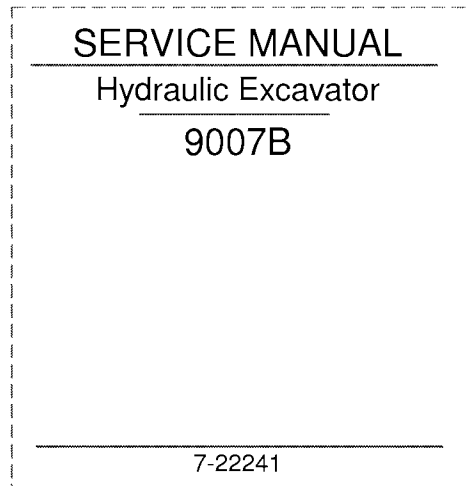

1. Trim along dashed line.
2. Slide into pocket on Binder Spine.

TYPE 1-4

9007B HYDRAULIC EXCAVATOR

Table of contents

DIVISION/SECTION	SECTION N°	REFERENCE N°
1 GENERAL		
Safety, general information and torque specifications	1001	7-21930GB
Specifications	1002	7-23020
2 ENGINE		
Engine removal and installation	2000	7-21950GB
Radiator and oil cooler	2001	7-21960GB
Diesel engine specifications details	2402	
3 FUEL SYSTEM		
4 ELECTRICAL		
Electrical schematics	4001	7-22810
Battery testing, maintenance and booster battery connections	4002	7-22000GB
5 STEERING		
Tracks, rollers and idlers	5002	7-22020GB
6 POWER TRAIN		
Travel motor and travel reduction gear	6002	7-22030GB
Swing motor and swing reduction gear	6003	7-22041GB
7 BRAKES		
8 HYDRAULICS		
Cleaning the hydraulic system	8000	7-22050GB
Hydraulic schematic, inspections, adjustments and troubleshooting	8001	7-22820
Hydraulic pump	8002	7-22070GB
Attachment, swing and travel control valves	8003	7-22081GB
Attachment and dozer blade cylinders	8004	7-22090GB
Hand control valves, foot control valves, shuttle valve, travel shuttle valve and accumulator	8005	7-22100GB
Electro-control valve block	8006	7-22110GB
Cushion valve	8007	7-22120GB
Auxiliary hydraulics	8008	
Hydraulic pilot filter, hydraulic inline filter and bypass oil filter	8011	
Hydraulic swivel	8013	7-22150GB
9 MOUNTED/EQUIPMENT		
Upperstructure and turntable bearing	9002	7-22160GB
Boom, arm, bucket and blade	9003	7-22170GB
Seat mounting and belts	9004	
Cab and cab equipment	9005	7-26100
Air conditioner troubleshooting	9006	
Air conditioner system service	9008	
Air conditioner components service	9009	
Hydraulic and electrical schematics foldout	in rear pocket	7-22611
Hydraulic and electrical schematics foldout (options)	in rear pocket	

Sections to be distributed at a later date

Reprinted

Section

1001

SAFETY, GENERAL INFORMATION AND TORQUE SPECIFICATIONS

TABLE OF CONTENTS

GENERAL INFORMATION	3
SAFETY.....	4
STANDARD TORQUE DATA FOR CAP SCREWS AND NUTS.....	6



WARNING : *This symbol is used in this manual to indicate important safety messages. Whenever you see this symbol, carefully read the message that follows, as there is a risk of serious injury.*

GENERAL INFORMATION

Cleaning

Clean all metal parts except bearings, in a suitable cleaning solvent or by steam cleaning. Do not use caustic soda for steam cleaning. After cleaning, dry and put oil on all parts. Clean oil passages with compressed air. Clean bearings in a suitable cleaning solvent, dry the bearings completely and put oil on the bearings.

Inspection

Check all parts when the parts are disassembled. Replace all parts that have wear or damage. Small scoring or grooves can be removed with a hone or crocus cloth. Complete a visual inspection for indications of wear, pitting and the replacement of parts necessary to prevent early failures.

Bearings

Check bearings for easy action. If bearings have a loose fit or rough action replace the bearing. Wash bearings with a suitable cleaning solvent and permit to air dry. **DO NOT DRY BEARINGS WITH COMPRESSED AIR.**

Needle bearings

Before you press needle bearings in a bore always remove any metal protrusions in the bore or edge of the bore. Before you press bearings into position put petroleum jelly on the inside and outside diameter of the bearings.

Gears

Check all gears for wear and damage. Replace gears that have wear or damage.

Oil seals, O-rings and gaskets

Always install new oil seals, O-rings and gaskets. Put petroleum jelly on seals and O-rings.

Shafts

Check all shafts that have wear or damage. Check the bearing and oil seal surfaces of the shafts for damage.

Service parts

Always install genuine Case service parts. When ordering refer to the Parts Catalog for the correct part number of the genuine Case replacement items. Failures due to the use of other than genuine Case replacement parts are not covered by warranty.

Lubrication

Only use the oils and lubricants specified in the Operator's or Service Manuals. Failures due to the use of non-specified oils and lubricants are not covered by warranty.

SAFETY



*This symbol means **ATTENTION! BECOME ALERT! YOUR SAFETY IS INVOLVED.** The message that follows the symbol contains important information about safety. Carefully read the message. Make sure you fully understand the causes of possible injury or death.*

To prevent injury always follow the Warning, Caution and Danger notes in this section and throughout the manual.

Put the warning tag shown below on the key for the keyswitch when servicing or repairing the machine. One warning tag is supplied with each machine. Additional tags Part Number 331-4614 are available from your service parts supplier.

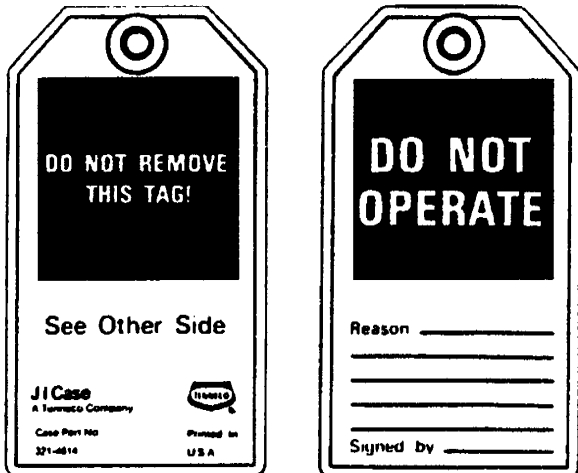

JS00480A



WARNING: Read the operator's manual to familiarize yourself with the correct control functions.



WARNING: Operate the machine and equipment controls from the seat position only. Any other method could result in serious injury.



WARNING: This is a one man machine, no riders allowed.



WARNING: Before starting engine, study Operator's Manual safety messages. Read all safety signs on machine. Clear the area of other persons. Learn and practice safe use of controls before operating.

It is your responsibility to understand and follow manufacturers instructions on machine operation, service and to observe pertinent laws and regulations. Operator's and Service Manuals may be obtained from your Case dealer.



WARNING: If you wear clothing that is too loose or do not use the correct safety equipment for your job, you can be injured. Always wear clothing that will not catch on objects. Extra safety equipment that can be required includes hard hat, safety shoes, ear protection, eye or face protection, heavy gloves and reflector clothing.



WARNING: When working in the area of the fan belt with the engine running, avoid loose clothing if possible, and use extreme caution.



WARNING: When doing checks and tests on the equipment hydraulics, follow the procedures as they are written. **DO NOT** change the procedure.



WARNING: When putting the hydraulic cylinders on this machine through the necessary cycles to check operation or to remove air from a circuit, make sure all people are out of the way.



WARNING: Use insulated gloves or mittens when working with hot parts.



WARNING: Lower all attachments to the ground or use stands to safely support the attachments before you do any maintenance or service.



WARNING: Pin sized and smaller streams of hydraulic oil under pressure can penetrate the skin and result in serious infection. If hydraulic oil under pressure does penetrate the skin, seek medical treatment immediately. Maintain all hoses and tubes in good condition. Make sure all connections are tight. Make a replacement of any tube or hose that is damaged or thought to be damaged. **DO NOT** use your hand to check for leaks, use a piece of cardboard or wood.



WARNING: When removing hardened pins such as a pivot pin, or a hardened shaft, use a soft head (brass or bronze) hammer or use a driver made from brass or bronze and a steel head hammer.



WARNING: When using a hammer to remove and install pivot pins or separate parts using compressed air or using a grinder, wear eye protection that completely encloses the eyes (approved goggles or other approved eye protectors).



WARNING: Use suitable floor (service) jacks or chain hoist to raise wheels or tracks off the floor. Always block machine in place with suitable safety stands.



WARNING: When servicing or repairing the machine, keep the shop floor and operator's compartment and steps free of oil, water, grease, tools, etc. Use an oil absorbing material and/or shop cloths as required. Use safe practices at all times.



WARNING: Some components of this machine are very heavy. Use suitable lifting equipment or additional help as instructed in this Service Manual.



WARNING: Engine exhaust fumes can cause death. If it is necessary to start the engine in a closed place, remove the exhaust fumes from the area with an exhaust pipe extension. Open the doors and get outside air into the area.



WARNING: When the battery electrolyte is frozen, the battery can explode if (1), you try to charge the battery, or (2), you try to jump start and run the engine. To prevent the battery electrolyte from freezing, try to keep the battery at full charge. If you do not follow these instructions, you or others in the area can be injured.

STANDARD TORQUE DATA FOR CAP SCREWS AND NUTS

Tightening of cap screws, nuts

Tighten alternately so that tightening torque can be applied evenly. The numbers in the figure below indicate the order of tightening.

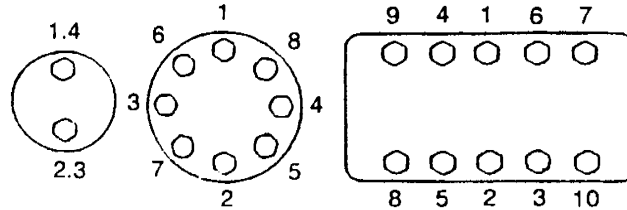

JS00481A

Apply engine oil to the thread portion of the cap screw so that uniform tightening torque is obtained. The cap screws and nuts that cannot be inspected externally or those as indicated in the assembly/installation sections should be safetied with lockwire, cotter pin or bent washer.

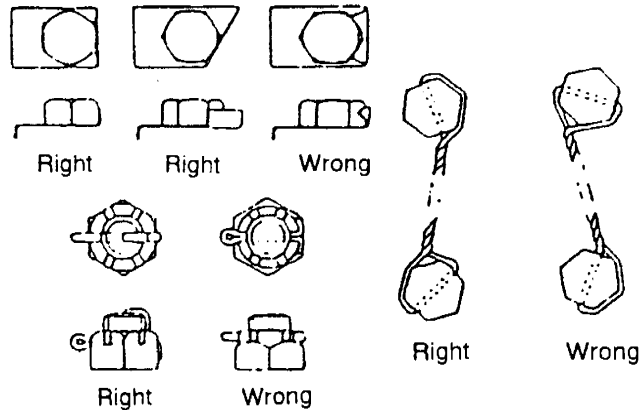

JS00482A

Cap screws which have had Loctite used (white residue remains after removal) should be cleaned with light oil or suitable cleaning solvent and dried. Apply 2-3 drops of Loctite to the thread portion of the cap screw and then tighten.

Torque table

Tighten cap screws and nuts according to the table below if there are no other special instructions.

Cap Screw Name Size (Size)			M6	M8	M10	M12	M14	M16	M18	M20
Cap Screw	Spanner	[mm]	10	13	17	19	22	24	27	30
		[in.]	0.39	0.51	0.67	0.75	0.87	0.95	1.06	1.18
	Tightening torque	[Nm]	6.9	15.7	32.3	58.8	98.0	137.2	196.0	274.0
		[lb-ft]	5.1	11.6	23.9	43.4	72.3	101.2	144.6	202.4
Socket Head Cap Screw	Spanner	[mm]	5	6	8	10	12	14	14	17
		[in.]	0.20	0.24	0.32	0.39	0.47	0.55	0.55	0.67
	Tightening torque	[Nm]	8.8	21.6	42.1	78.4	117.6	176.4	245.0	343.0
		[lb-ft]	6.5	15.9	31.1	57.8	86.8	130.1	180.8	253.1

Section

1002

SPECIFICATIONS

TABLE OF CONTENTS

FLUIDS AND LUBRICANTS	3
Hydraulic fluid.....	3
Final drive gear boxes.....	3
Grease	3
Engine oil	4
Oil viscosity/Oil range.....	4
Fuel	5
Anti-freeze/Anti-corrosion.....	5
Capacities	5
ENVIRONMENT	5
SYSTEMGARD LUBRICATION ANALYSIS PROGRAM	6
MACHINE GENERAL SPECIFICATIONS.....	6
Engine	6
Hydraulic system.....	6
Undercarriage	7
Indicators and gauges.....	7
Weights	7
Arm.....	7
Dozer blade.....	7
Tracks, Rollers and Idlers	8
Gauge table.....	14
MACHINE OVERALL DIMENSIONS.....	16
WORKING RANGE	17

FLUIDS AND LUBRICANTS

Lubricants must have the correct properties for each application.

 **WARNING :** *The conditions of use for individual fluids and lubricants must be respected.*

Hydraulic fluid

Use only hydraulic oils meeting Case specifications or equivalent AW (anti-wear) hydraulic oils.

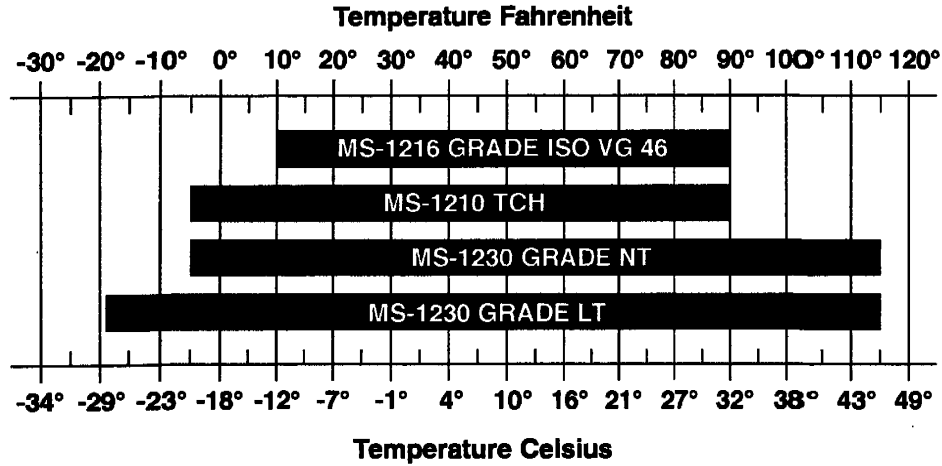

CS99B506

NOTE : *Case specification MS-1210 TCH Fluid is used in place of ISO VG 32 (-5 to +65°F) and ISO VG 46 (+10 to +90°F).*

Case specifications MS-1230 Grade NT or Grade LT is used in place of ISO VG 32 (-5 to +65°F), ISO VG 46 (+10 to +90°F), ISO VG 100 (+30 to +115°F), and MS-1210 TCH.

Final drive gear boxes

Extreme pressure oil used for enclosed transmission components.
 Extreme pressure oil type API GL5 grade 80W90 or ISO VG 150 or CASE 135H Gear lube.

Grease

No. 2 EP Lithium Grease or Molydisulfide Grease.

Engine oil

CASE N°1 motor oil is the oil recommended for your engine. This oil ensures correct lubrication of your engine in all working conditions.

If CASE N°1 Multiperformance or Performance engine oil cannot be obtained, use only oil of the API/CG/CF category.

NOTE : Do not put any Performance Additive or other additive in the sump. Oil change intervals shown in the Operator's manual are based on tests carried out on CASE lubricants.



RB97F156



RB97F100

Oil viscosity/Oil range

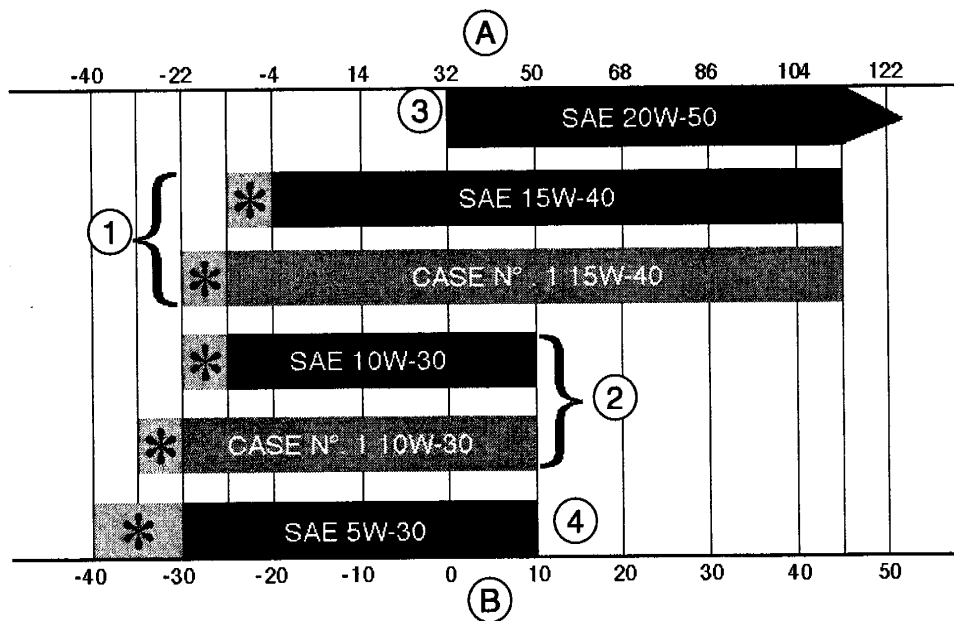

CS98M561

(A) Fahrenheit Temperature

(B) Celsius Temperature

(1) All seasons

(2) Winter

(3) Tropical

(4) Arctic

(*) Use of an engine oil heater, or engine coolant heater is required.

Thanks for your reading.

Please click here to download complete manual instantly.

And can also choose other manuals.

Feel free --->write to me with any questions.

Our service email:

manuals007@hotmail.com